

**Wildlife and Countryside Act 1981**

**West Berkshire District Council Second Consolidated Definitive Map and Statement**

**West Berkshire District Council (Purley-on-Thames, Springs Farm Public Footpath) Definitive Map Modification Order 2019**

This Order is made by West Berkshire District Council under section 53(2)(b) of the Wildlife and Countryside Act 1981 ( "the Act") because it appears to that authority that the West Berkshire District Council Second Consolidated Definitive Map and Statement require modification in consequence of the occurrence of an event specified in section 53(3)(c)(i), namely, the discovery by the authority of evidence which (when considered with all other relevant evidence available to them) shows that a right of way which is not shown in the map and statement subsists or is reasonably alleged to subsist over land in the area to which the map relates, being a right of way such that the land over which the right subsists is a public footpath.

The authority has consulted with every local authority whose area includes the land to which the order relates. The West Berkshire District Council hereby order that:

1. For the purposes of this order the relevant date is 6<sup>th</sup> March 2019
2. The West Berkshire District Council Second Consolidated Definitive Map and Statement shall be modified as described in Part 1 and Part 2 of the Schedule and shown on the map attached to the Order
3. This order shall take effect on the date it is confirmed and may be cited as the West Berkshire District Council (Purley-on-Thames, Springs Farm Public Footpath) Definitive Map Modification Order 2019

**THE COMMON SEAL of WEST BERKSHIRE DISTRICT COUNCIL**  
hereunto affixed this 14<sup>th</sup> day of  
March..... 2019 is authenticated by:-

  
Authorised Signatory

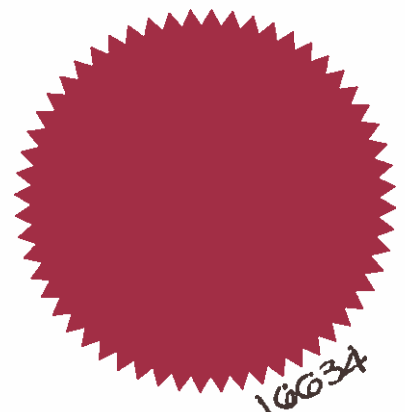

## SCHEDULE

### PART 1

#### Modification of Definitive Map

Description of path to be added:

#### **Public Footpath Purley-on-Thames 15**

A public footpath in the parish of Purley-on-Thames running from point A (Grid Reference 464900 176644) in a generally northerly direction for 168 metres to point A1 (Grid Reference 464871 176810) and then in a generally westerly direction for 358 metres to point B (Grid Reference 464515 176773) via point A2 (Grid Reference 464626 176784) as shown on the Order plan

Width: 2.5 metres

#### **Public Footpath Purley-on-Thames 15a**

A public footpath in the parish of Purley-on-Thames running from point A2 (Grid Reference 464626 176784) in a north-north-westerly direction for 92 metres to point C (Grid Reference 464588 176868) as shown on the Order plan

Width: 2.5 metres

### PART 2

#### Modification of Definitive Statement

Variation of particulars of path or way:

#### **Public Footpath Purley-on-Thames 15**

**From:** FP 1, N, then W

**To:** FP 7

**Width:** 2.5 metres

#### **Public Footpath Purley-on-Thames 15a**

**From:** FP 15, NNW

**To:** FP 7

**Width:** 2.5 metres

# West Berkshire District Council (Purley-on-Thames, Springs Farm Public Footpath) Definitive Map Modification Order 2019 (WB062)

Scale (on A4 paper): 1:2500

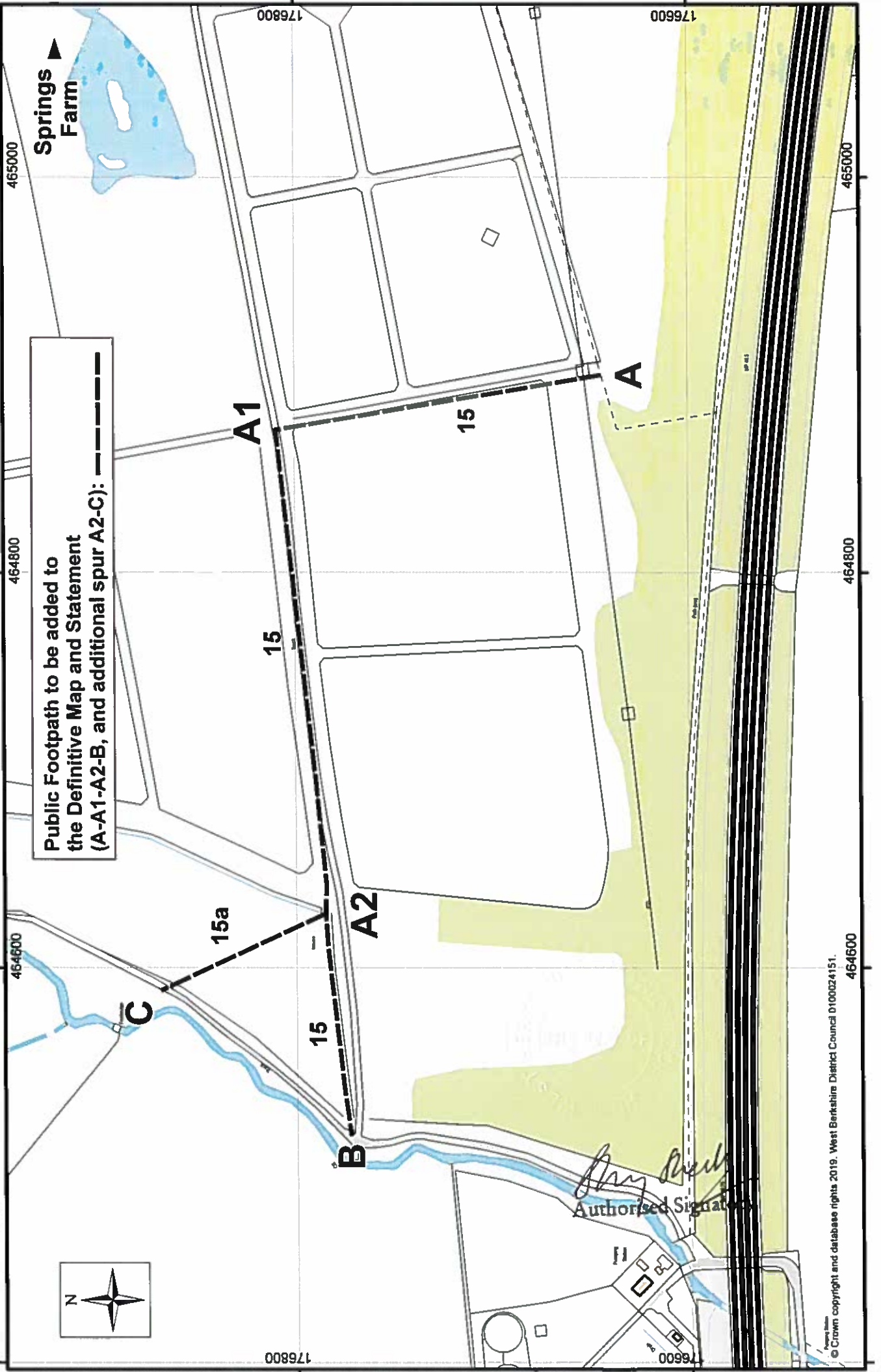

Public Footpath to be added to the Definitive Map and Statement (A-A1-A2-B, and additional spur A2-C): - - - - -



*Amy Smith*  
Authorized Signatory